

Tension Bow

1. Remove the bow tubes and their holding bolts (one side at a time) so that you can slide the tension bow mounting brackets over the pivot tubes (flat surface toward the box).
2. Position the tension bow mounting brackets on pivot tubes near the middle of the box and tighten the bolts just enough to keep them from sliding.
3. Measure from the bolt in the mounting bracket to Point A and Point B (see **Figure 19**). Adjust the mounting bracket until the bolt is the same distance from both points.

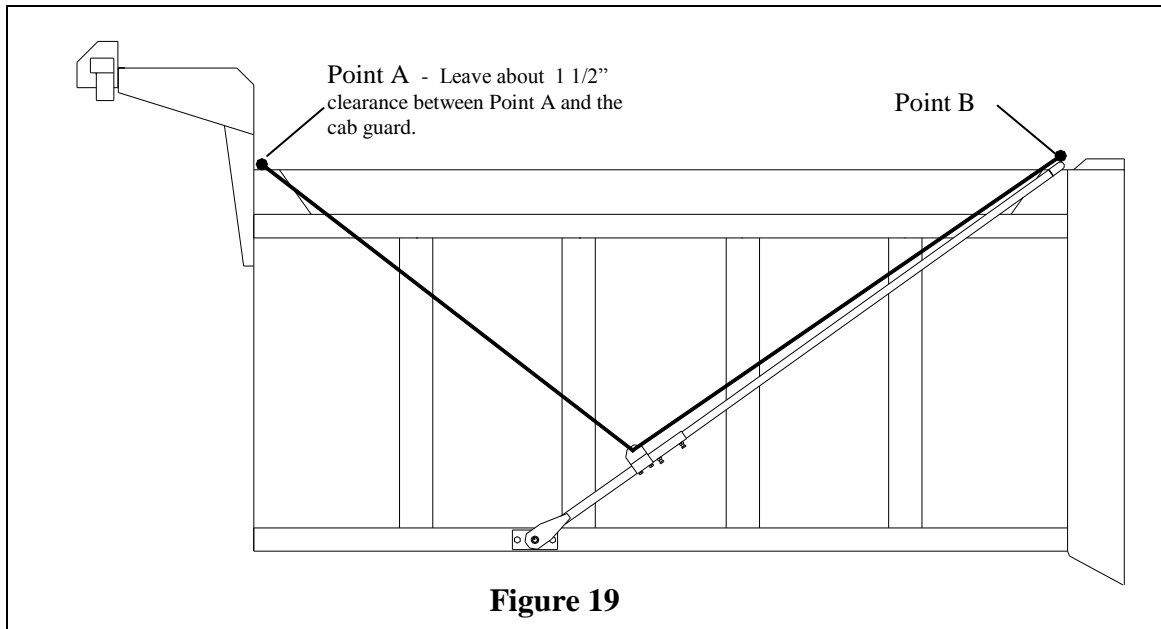

4. Place one of the tension bow arms over the tab mounted to the bracket installed in step 3 and bolt in place (see Fig. 20 on next page) If the tension bow mount and tab assembly is not assembled see assembly in Figure 21.
Note: If the tarp bow was angled to clear the cab door or the loading area, then the tension bow arms will have to be angled to match before beginning the next step.

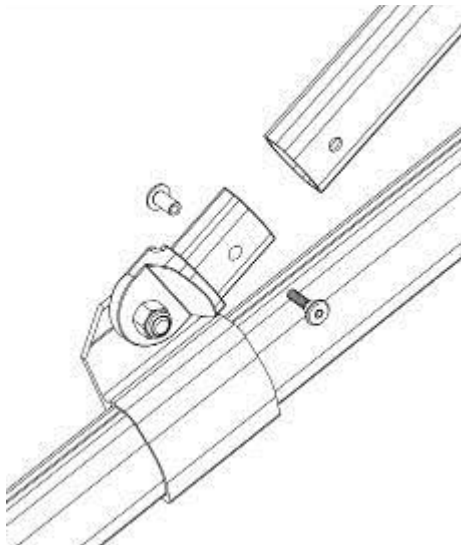

Fig. 20

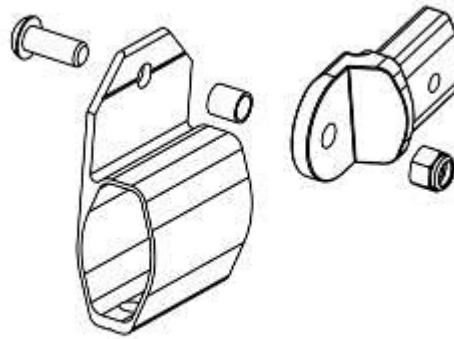

Fig. 21

5. Mark the tension bow arm where it rests on the seem between the corner and the bow arm (see **Figure 22**). Remove the side arm and cut **both** of the side arms to the length marked.
6. Drill the newly cut end of the side arm to match how it was drilled before it was cut off – 1" in from end and centered.
7. Repeat process above with opposite side.
8. Install the 90° corners in the newly cut ends of the tension bow side arms and bolt them in place (see fig. 23.) The corners should be pointing in toward the dump body at this point.

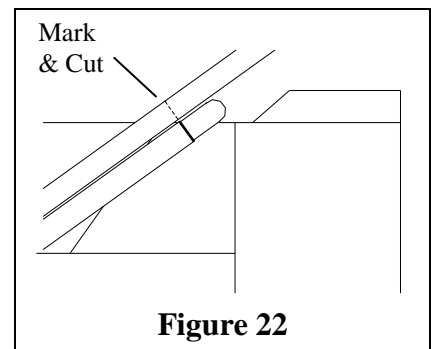

Figure 22

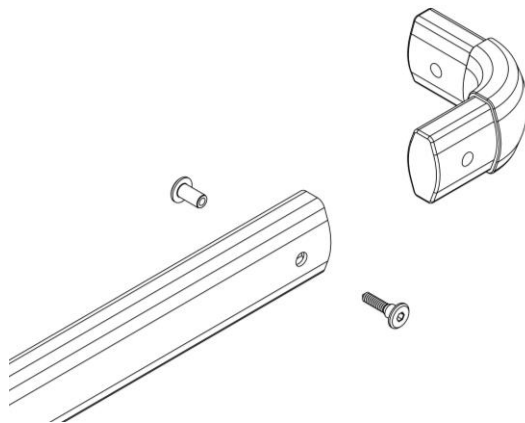

Fig. 23

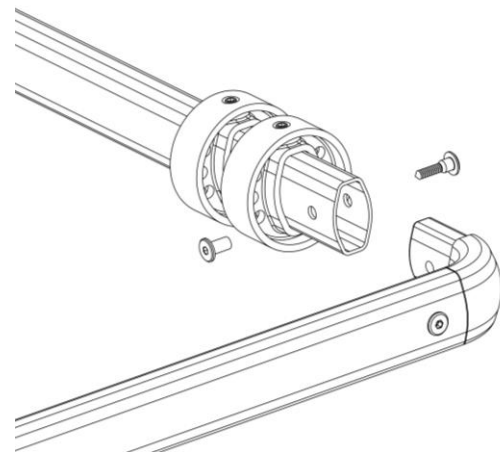

Fig. 24

9. Slide the pair of tarp flanges onto the rear bar and then connect the side arms by bolting the rear bar to the exposed ends of the 90° corners (see Fig. 24.)
10. Swing the tension bow forward. If there is not about 1 1/2" clearance between

the bow and the cab guard, make any necessary adjustments.

Final Adjustments

1. Swing both bows forward until they rest on the head assembly. The tension bow should rest in the middle of the head assembly opening and the tarp bow should be a little shorter than the tension bow. If not, reposition the mounting brackets and/or adjust the bows until they match **Figure 21**.

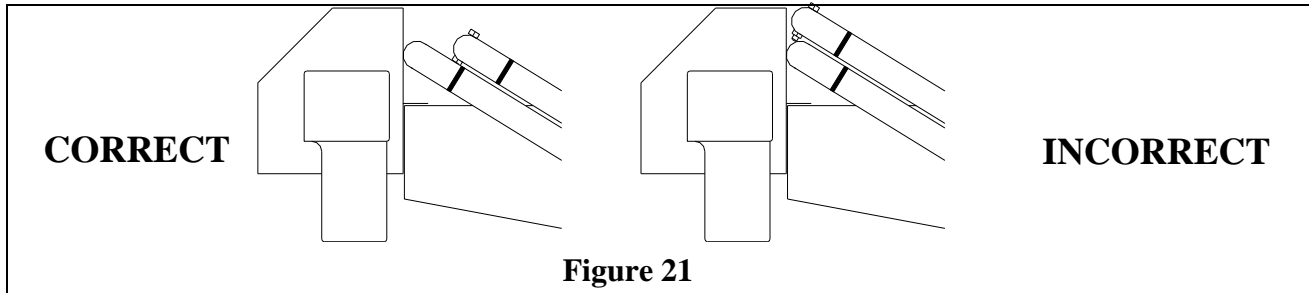

2. Check to see if the tension bow is catching on the lip of the head assembly as the tarp is wound in. In some situations where the head assembly has been mounted at the rear edge of the cab guard, the tension bow may pinch the tarp against the lip of the head assembly. In some cases this may trip the circuit breaker and/or tear the tarp. Adjust bows as necessary
3. Check all bolts for proper tightness.
4. Run the tarp in and out several times checking the bows for binding or rubbing against the sides of the box. Adjust as necessary.